

All in one design

MONO
V3

ASSEMBLY

All in one design

MONO V3

The Manta Mono v3 is also available with carbon mast and wings.
Fuselage assembly follows the same process as aluminum mast / Orange wings models.



All in one design

MONO V3

Many configurations are possible with the Mono v3 range.

The Mono v3 features a single fuselage with two masts fixing locations that enable to adjust the foil to the required foiling activity.

It is usually recommended for beginners to start with our 65cm aluminum mast, then progress towards our 86cm model or even upgrade to our 100cm carbon version.



F550 WING
KITEFOIL



F1100 WING
KITEFOIL
WINDFOIL
SURF FOIL



F770 WING
WINDFOIL



F800 WING
WINDFOIL



F1200 WING
WINDFOIL
SURF FOIL
SUPFOIL
WINGFOIL



F1800 WING
WINDFOIL
SUPFOIL
WINGFOIL



F2150 WING
WINDFOIL
SURF FOIL
SUPFOIL
WINGFOIL

MONO V3



Fully Dismountable

Easy to transport. All parts are exchangeable to allow upgrade or replacement.

TelGel (supplied with each foil) must be applied on each screw to reduce the risk of corrosion (Aluminum to Stainless steel galvanic corrosion in salt water).

It is recommended to clean the foil with clear water after each use.



Zinc Anode

A zinc anode is placed in the fuselage to improve galvanic corrosion resistance that happens in salt water environment.

The anode can be easily replaced when consumed.



TUTTLE

POWERBOX

PLATE

Different mast heads options

Manta Mono v3 aluminum mast is compatible with several mast heads standards and includes an optional load plate which ensures high rigidity and longevity.

A four holes plate head option allows compatibility with third party boards using plate systems / rails.

The powerbox head specially designed to upgrade your preferred windsurf board to windfoil. We strongly recommend the use of the extra load plate with the powerbox head.

*Mast heads also available on demands:
Probox and short tuttle.*

MONO V3



Removable load support plate

When windfoiling, the mast load on the fin box is very high and some non reinforced boards may break. In order to spread the load our mast head features built in load plate.

For extra safety, an optional removable wider plate system has been designed. The width of the plate further spreads the mast load over the bottom of the board thus reducing the risk of damaging the board.

Recommended for very large boards (100cm) and heavy / powerful windfoilers.
A Must when used with powerbox head.

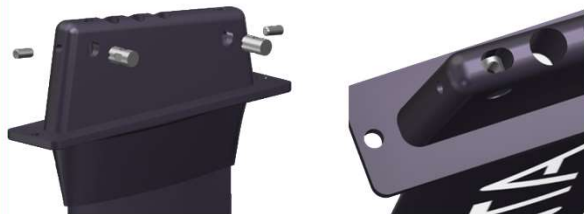

Tuttle Insert lock screws

To provide long lasting foil connection to the board we use 316 stainless steel inserts which are secured in position thanks to some perpendicular screws.

This setup allows easy replacement and a well secured insert.

The use of 316 stainless steel inserts and screws is a much safer and stronger connection than aluminum threads or brass inserts found with most competitors.

We also machined oblong hole to allow easy screw angle adjustment when board box are not perfectly drilled in line with the head.



Adjustable stabilizer angle

Each board setup and wing need a tiny adjustment to perfectly fit rider's individual balance.

The Manta Mono V3 is no exception to our previous ranges and features an improved stabilizer angle adjustment.

The tuning is performed thanks to two counter screws to allow easy and fast tuning.

MONO V3



Aluminum / carbon masts

The Mono v3 features the same mast to fuselage connection as the arrow series.

This allows the use of both aluminum and carbon masts making the mono v3 the most complete range we ever produced.

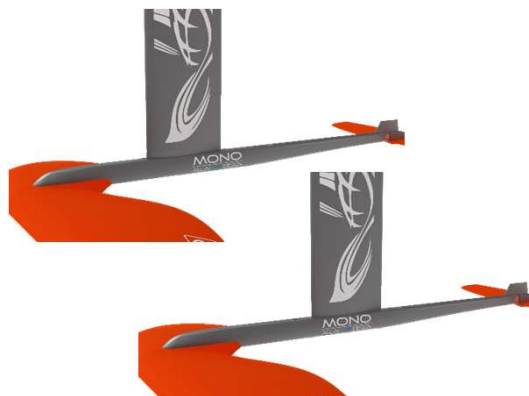

Dual mast positions

Manta Mono v3 when configured with aluminum mast allows two masts positions. A front position more suitable for kitefoil and some surf foils, and a back position that fits windfoil, wingfoil, sup foil.

There is no need for extra hardware, the foil comes with all what you need to achieve the 2 positions.

Swapping from one to an other is just a matter of screws.

A plastic cap is supplied to cover the unused hole.



Optional load plate

Mono v3 carbon mast also features a load plate to enhance the board's rigidity and reduce the risk of damages, especially when in use for windfoiling.

MONO ALL IN ONE DESIGN V3



FRONT WING

F550

kitefoil freeride - intermediate level



F770

windfoil freeride - all levels



F800

windfoil freerace - intermediate level



F1100

kitefoil - starter / intermediate level
windfoil - All levels
surf/supfoil - intermediate level - Fast



F1200

kitefoil - starter / intermediate level
windfoil - All levels
surf/supfoil - all levels - all waves



F1800

windfoil - All levels - low speed
surf/supfoil - all levels - all waves - slow



F2150

windfoil - All levels - low speed
surf/supfoil - all levels - all waves
wingfoil - all levels



MAST



65cm
Learning
kitefoil
windfoil
surf/supfoil



86cm
Standard
kitefoil
windfoil
surf/supfoil



110cm
kitefoil
windfoil



100cm carbon
kitefoil
windfoil

MAST HEAD



Chinook Deep Tuttle (Standard)
optional load plate



Short Tuttle
optional load plate



Powerbox
mandatory load plate



Probox
optional load plate



Plate head
160x90mm holes

LOAD PLATE



optional - reduce fin box load

ACCESSORIES



Aluminum mast adapter



Plastic front hole cap

FUSELAGE



front mast position:
kitefoil / surf/supfoil

back mast position:
windfoil
surf/supfoil
wingfoil

TAIL



for carbon
stabilizer



for fiberglass
stabilizer

STABILIZER



S205
high speed



S260
Standard stabilizer

MONO foil bag

Each Mono foil is supplied with a transport bag, and individual wings and mast covers. Protecting the most sensitive elements of the foil at all times.



MONO FOIL ASSEMBLY

We recommend to rinse the foil with clear water and apply TefGel in each thread to reduce the risk of galvanic corrosion between stainless steel screws and aluminum.

Note that the zinc Anode screw of the arrow foil shall not be covered by tefgel as it would prevent the anode to play its protection role.



MAST HEAD ASSEMBLY

Use M6 Grub screws to secure round inserts



1

M8x50 socket x3pcs



2



3

MAST HEAD ASSEMBLY

The extra load plate is recommended for windfoils to reduce board fin box load.
Mast and head can be secured by either 2 or 3 screws.

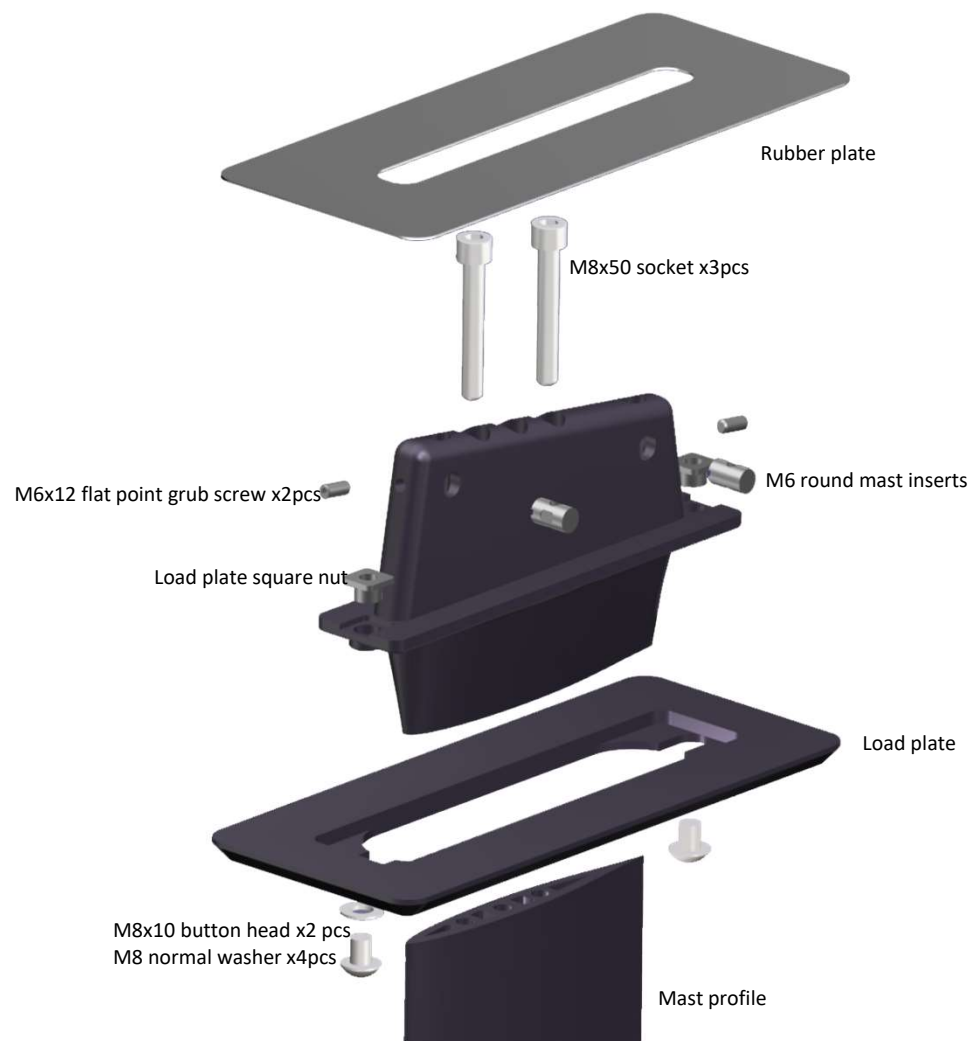

MAST HEAD ASSEMBLY

The extra load plate is recommended for windfoils to reduce board fin box load.

When using powerbox head the Mast and head are secured by 2 screws. A third long screw connects the board and mast together.

It is recommended to have this screw engaged at least 30mm in the mast threads.

Load plate is highly recommended for powerbox boards as usually their construction is weaker than tuttle box boards.

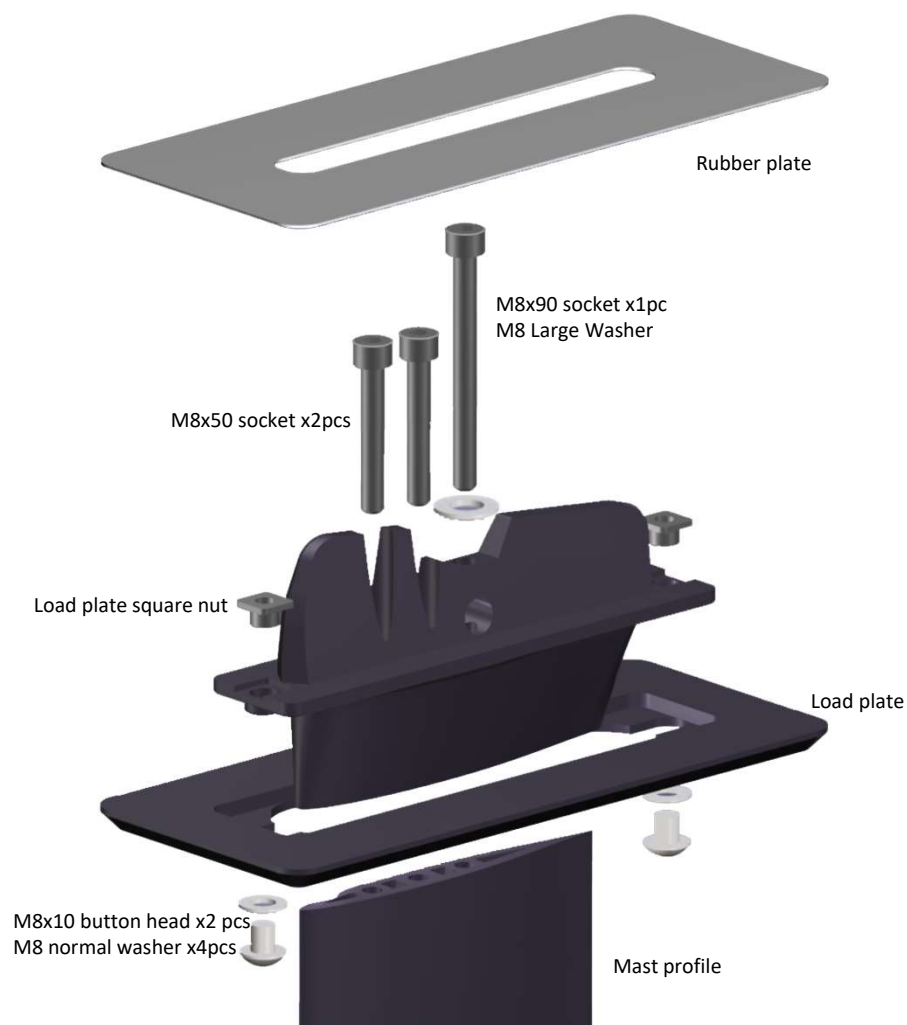

MAST HEAD ASSEMBLY

The plate head allow easy fixing on many foil boards. Our plate Follows the widely spread 165x90mm holes spacing.

It also accommodate few other standards thanks to its clamping shape.

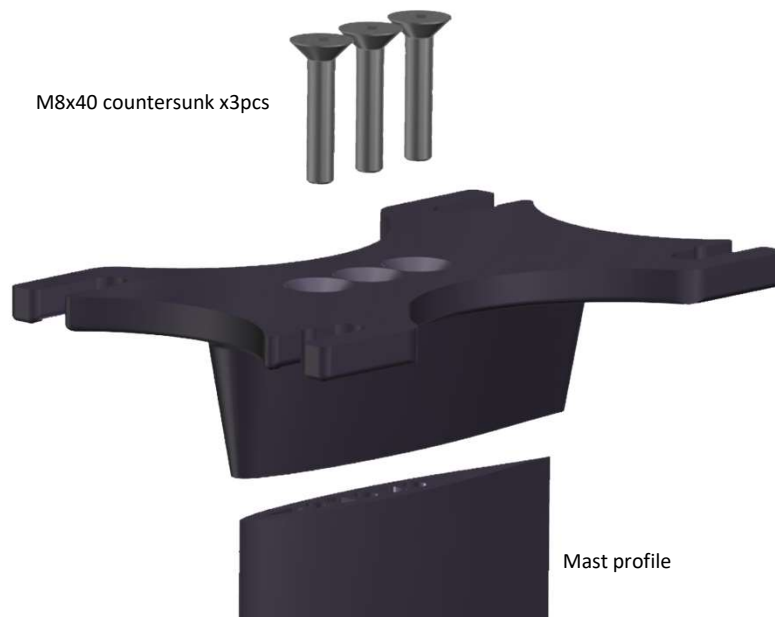

MONO V3 FUSELAGE



MONO V3 FUSELAGE



Insert fully the M5 grub screw

1

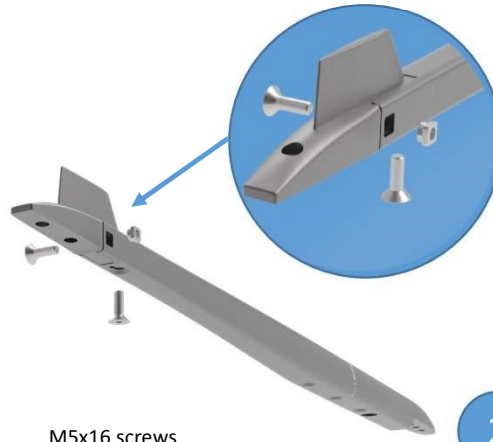

M5x16 screws
+ special M5 square nut
(pay attention to nut orientation)

2



Stabilizer angle is adjusted by having the grub screw
and the countersunk screw work in opposition, locking
the stab angle

3

MONO V3 MAST BOTTOM



MONO V3 FUSELAGE



Push in the hole cap

1



Screw the anode in place

2



Assemble the wings with provided screws

3

MONO V3 SWITCH MAST POSITION



Remove the hole cap and secure it into the mast base pocket

1



Remove the M8 screws and move the mast forward then screw back in the new position

2



Screw all back in

3

Assemble the wings with provided screws

MONO FOIL ASSEMBLY

	Front Wing	Recommended screws
	F550	M8x20 countersunk x 2pcs
	F770	M8x20 countersunk x 2pcs
	F800	M8x20 countersunk x 3pcs
	F1100	M8x20 countersunk x 2pcs
	F1200	M8x30 countersunk x 2pcs
	F1800	M8x30 countersunk + M8x35 countersunk
	F2150	M8x30 countersunk x 3pcs



MANTAFOILS

WWW.MANTAFOILS.COM